

PLEATED BLINDS DF

Data sheets

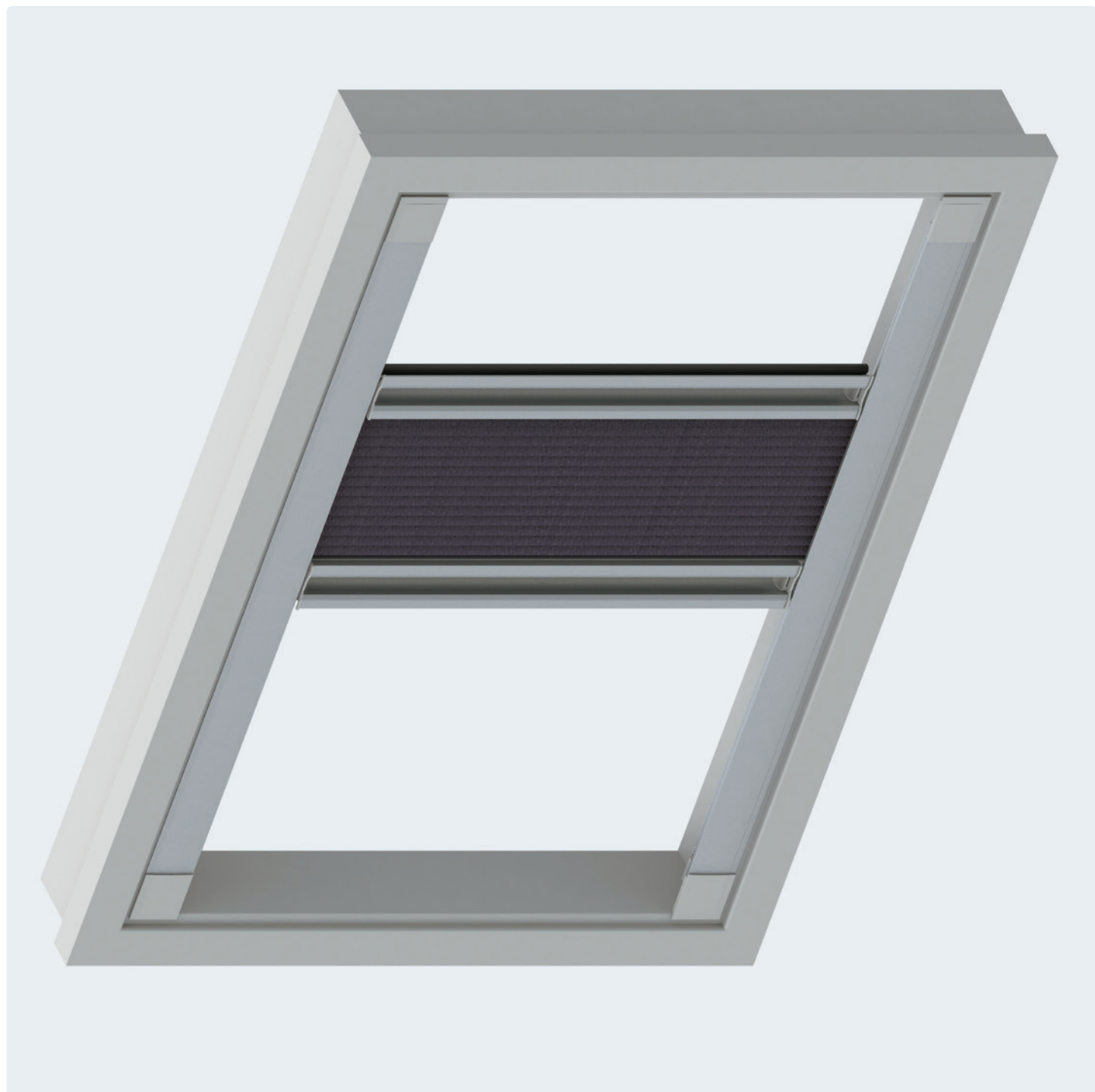

BENTHIN

P2660 - Roof window pleated blind with handle profile, side guiding profiles and variable hanging.

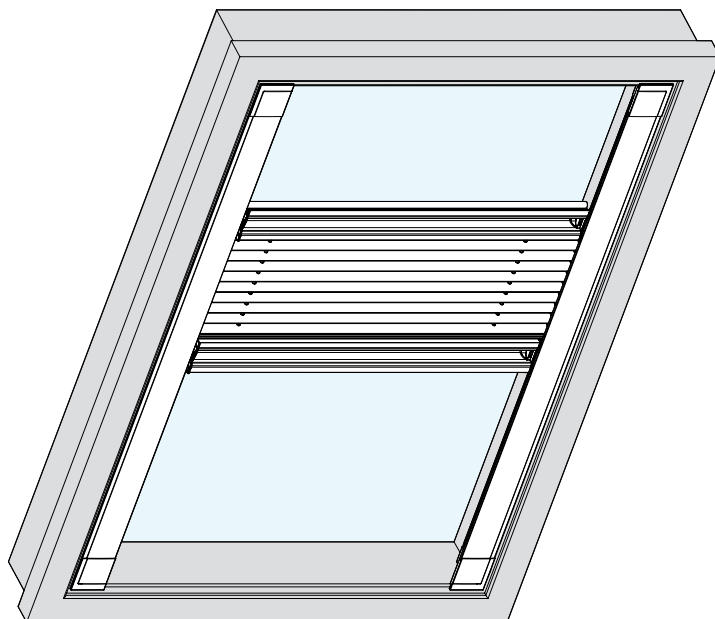

Pleated blind dimensions

- **Width:** min. 0.20 m
max. 1.50 m (depending on the fabric)
- **Height:** min. 0.20 m
max. 1.60 m (depending on the fabric)
- **Surface:** max. 2.40 m²
- **Installation depth:** min. 27 mm
- **Roof pitch angle:** 20°-90°

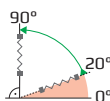

Mechanics

- Pleated fabric between two profile rails.
- Two-part handle profile (handle profile and fabric profile)
- Closed, tensioned cord system where the cord tension can be corrected.
- Cords of polyester yarn, Ø0.8 mm
- Hole punching (Ø6.0 mm) provided with abrasion-resistant plastic cord eyelets.
- Optional: operating rod (anodised aluminium rod E6/EV1) with plastic joint.

Control

- Fabric curtain can be stopped at any desired position by means of a **handle profile**.
- Optional: operating rod (anodised aluminium rod E6/EV1) with plastic joint.

Profiles/colours

- **Two-part handle profile** (34.4 x 28 mm) and **side profile** (33 x 26.5 mm) made of extruded aluminium (Al Mg Si 0.5 F22) powder coated white (RAL 9016) or technically anodised according to E6/EV1.
- **Plastic parts** made of high-quality, temperature-resistant and abrasion-resistant plastic.
- **Visible plastic parts** in white or grey to match the profile colours.
- **Profile end caps** made of black plastic, lacquered in white or grey to match the profile colour.

Fabric

- Pleated fabric hangings • 20 mm pleat width • visible hole (Ø3.5 mm) for cord guidance
- Honeycomb fabrics • 25 mm width • invisible hole (Ø3.5 mm) for cord guidance
- Distance between the cords 0.35 or 0.90 m (dependent on the fabric)

Mounting

- Direct screwing of the side profiles (screws DIN 7981 Ø3.5 x 19 mm).
- Optional: Universal bracket (screws DIN 7982 Ø2.9 x 9.5 mm) as mounting aid.

Option

- **Operating rod** - Anodised rod with joint, engages in the receptacle on the handle profile. Length: 1.00 m, 1.50 m, 2.00 m und 2.50 m.

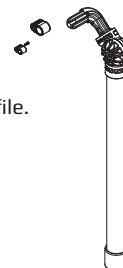

P2660 - Roof window pleated blind with handle profile, side guiding profiles and variable hanging.

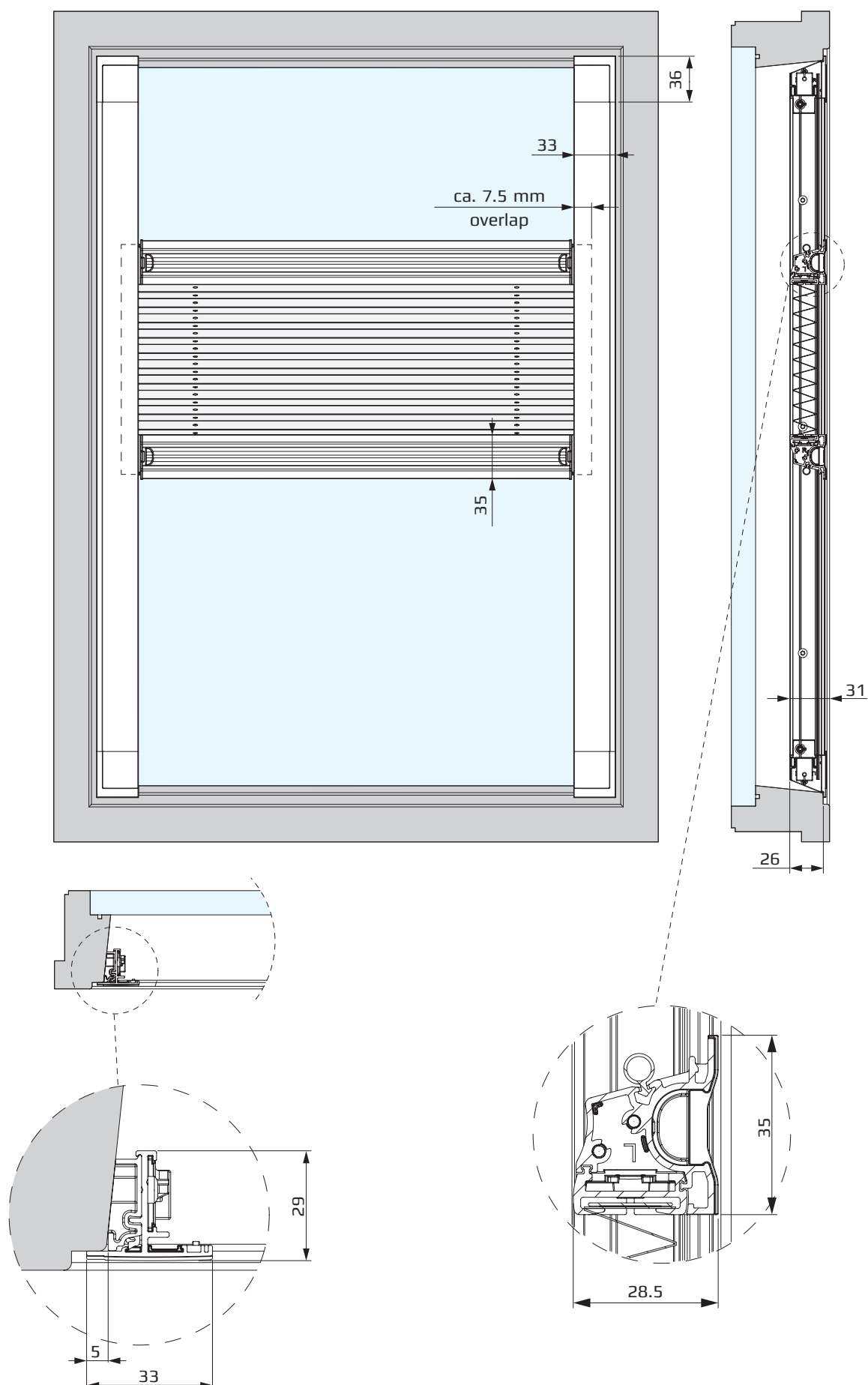

P2690 - Roof window pleated blind with drive in motor profile, side guiding and curtain at top.

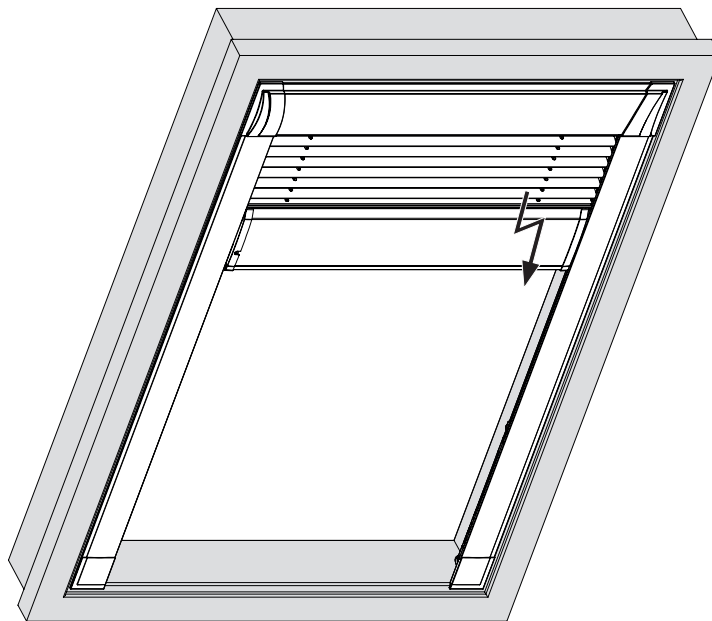

Pleated blind dimensions

- **Width:** min. 0.40 m
max. 1.50 m (dependent on the fabric)
- **Height:** min. 0.40 m
max. 1.60 m (dependent on the fabric)
- **Surface:** max. 2.40 m²
- **Installation depth:** min. 27 mm
(Cassette profile)
- **Roof pitch angle:** 20°-90°
- **Frame depth:** min. 38 mm

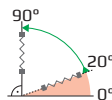

Gear/Hardware

- Pleated fabric between two profile rails
- Closed, tensioned cord system, cords made of polyester yarn, Ø0.8 mm
- **Motor drive and power supply (battery/solar)** in the movable motor profile.
The operation is carried out by a radio remote control and allows precise, stepless positioning of the pleated fabric in any desired position.
- Multiple protection by chain safety device, slip clutch and motor overload protection.
- **Motor profile** (64 x 38,5 mm), **Cover profile** (50 x 58 mm) and **Side profile** (33 x 29 mm) made of extruded aluminium (Al Mg Si 0.5 F22) powder-coated white (RAL 9016) or technically anodised according to E6/EV1.
- **Plastic parts** made of high-quality, temperature-resistant and abrasion-resistant plastic.
- Visible **plastic parts** in white or grey to match the profile colours.
- **Profile end caps** made of black plastic, lacquered in white or grey to match the profile colour.
- **Mounting components** in red.
- Hole punching (Ø6.0 mm) provided with abrasion-resistant plastic cord eyelets

Fabric

- Pleated fabric hangings • 20 mm pleat width • visible drilled hole (Ø3.5 mm) for cord guiding
- Honeycomb fabrics • 25 mm width • invisible drilled hole (Ø3.5 mm) for cord guiding
- Distance between the cords 0.35 or 0.90 m (dependent on the fabric)

Mounting

- Cover profile mounting by means of holder set (screws DIN 7982 Ø2.9 x 9.5 mm).
- Holder mounting (screws DIN 7982 Ø2.9 x 13 mm or steel nails Ø2.0 x 25 mm).
- Side profile mounting (screws DIN 7982 Ø3.5 x 16 mm).

P2690 - Roof window pleated blind with drive in motor profile, side guiding and curtain at top.

Drive

- **Plug-in drive SOMFY Tilt & Lift 25 RTS central - 12 V**
 - Dimension: Ø24 x 207 mm • Rated voltage: 12 V • Max. Current consumption: 0.7 A
 - Rated torque: 0.8 Nm • Rated speed: 33 rpm • High frequency: 433.42 MHz
 - Operating temperature: 0° - 60°C • Weight: 0.215 kg • Protection class: IP 20
 - Antenna: 18 cm cable, must not be shortened or extended
- **Power supply: NiMH battery pack**
 - Dimension Ø260 x 29 x 14.5 mm • Weight: 0.300 kg • Typ: NiMH • Rated voltage: 12 V
 - Nominal charge: 21.6 Wh • Charging capacity: approx. 200 - 220 cycles* • Capacity: 1800 mAH
 - 2x BEC plugs • Operating temperature: 0° to 70° C
 - * One cycle corresponds to the complete movement of the blind in both directions.*
 - The maximum number of cycles results from a window size (approx. 800 x 1000 mm), the selected motor, the self-discharge and the general wear and age of the battery.*
- **Solar module**
 - Clipped to the motor profile • Dimension: Ø350 x 40 x 2.5 mm • Weight: 0.300 kg
 - Type: Monocrystalline silicon • Nominal voltage: 12 V • Nominal peak power: 2 Wp
 - Maximum voltage: 16.5 V • Maximum power: 121 mA
 - Operating temperature: -40° bis 80° C • JST-PH connector
- **Charger for Battery pack:**
 - Input voltage: 230 V • Output voltage: 12 V • Max. current consumption: 0.5 A
 - Round plug: Ø3.5 mm • BEC plug • Cable: 3 m • incl. status LED
- **Charging cable adapter:**
 - Length: 170 mm • JST-RCI plug • Cable round socket (outside Ø3.6 mm, inside Ø1.3 mm)

P2690 - Roof window pleated blind with drive in motor profile, side guiding and curtain at top.

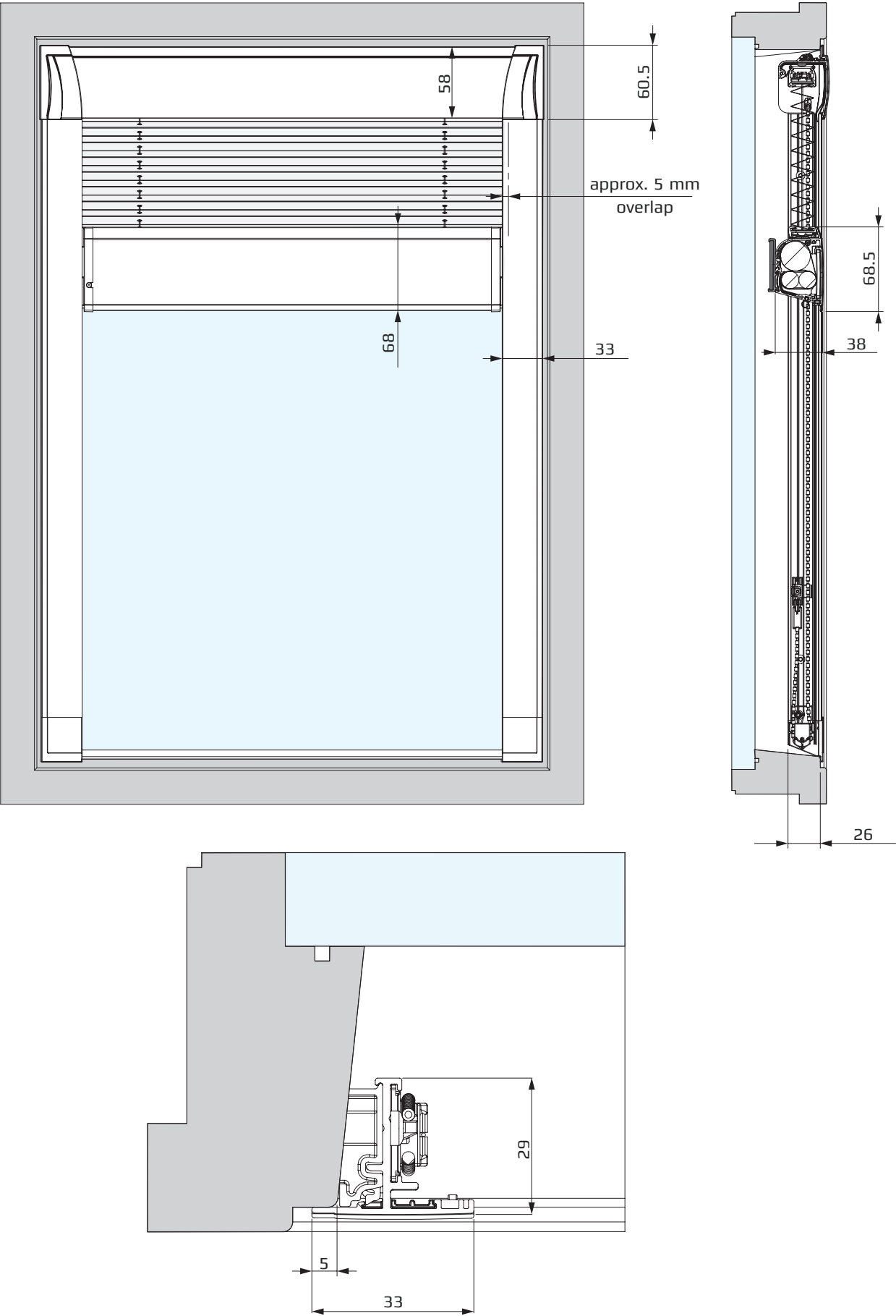

P2690 - Roof window pleated blind with drive in motor profile, side guiding and curtain at top.

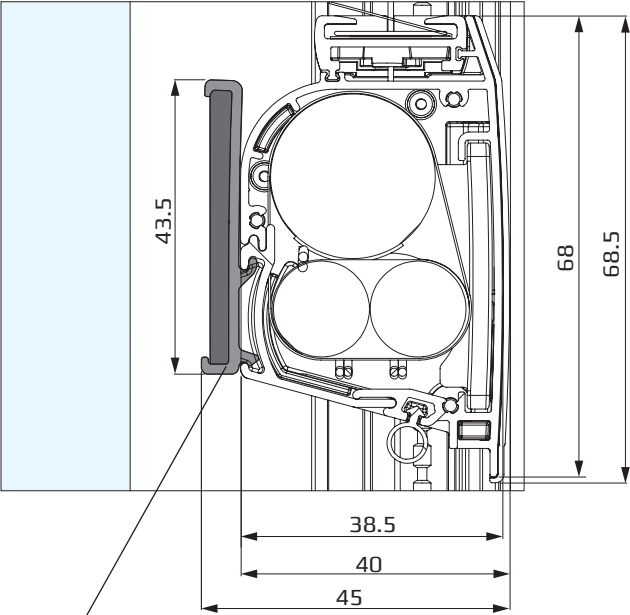
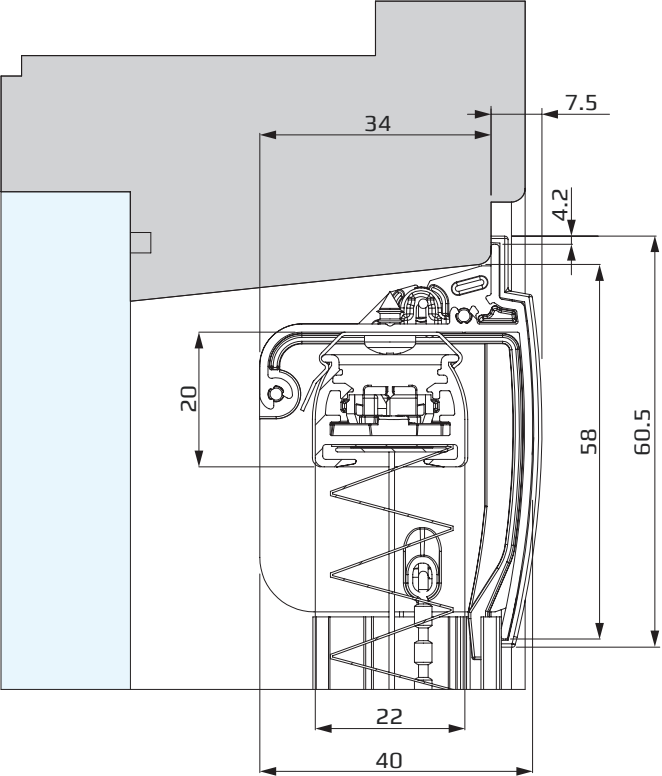

Solar panel
with clip



Benthin GmbH
Osterstader Str. 16
D-27572 Bremerhaven
T +49 471 79 84 0
info@benthin.com

Benthin
11 Brookfield
Duncan Close
Moulton Park Ind. Estate
Northampton NN3 6WL
T +44 1604 490580
F +44 1604 648446
info-uk@benthin.com

Benthin Systèmes E.U.R.L
27, Avenue de Montboulon
FR-77165 St. Souplets
T +33 1 60 61 56 56
info@benthin.fr

www.benthin.com