

Operation

Child safety Model P3700

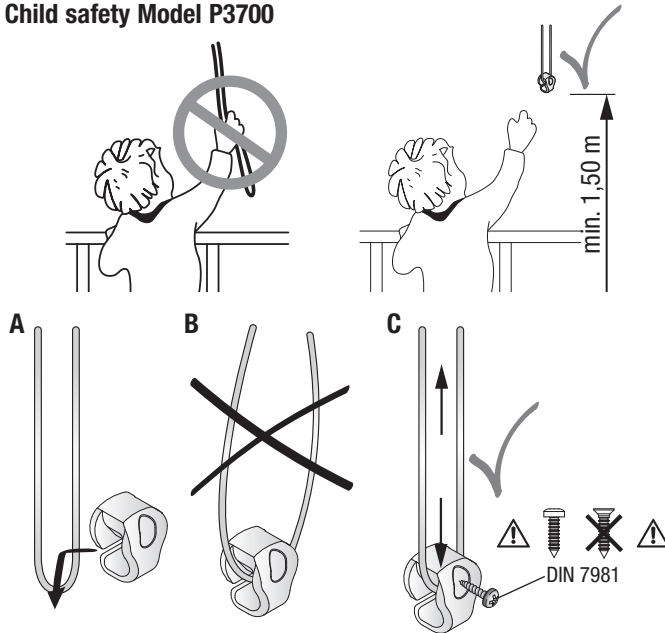

Operation Model P3700

Pleated blinds with cord operation are opened and closed by pulling the operating cord.

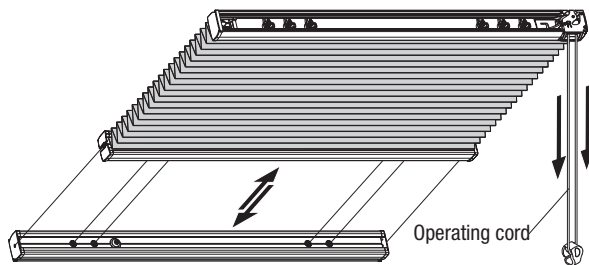

Operation Model P3900, P3902

Pleated blinds with motorised operation. Please note the installation instructions "Electrical installation".

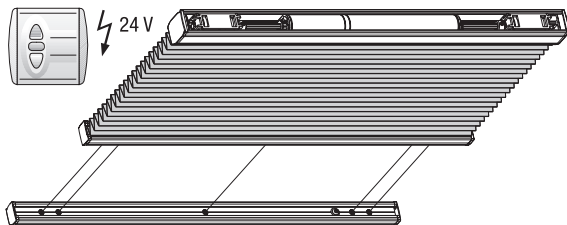

Operation

Operation Model P3800, P3802

Pleated blinds with crank drives are opened or closed by turning the crank handle or motorised handle.

Attach the crank handle/motorised handle to the crank gear box.

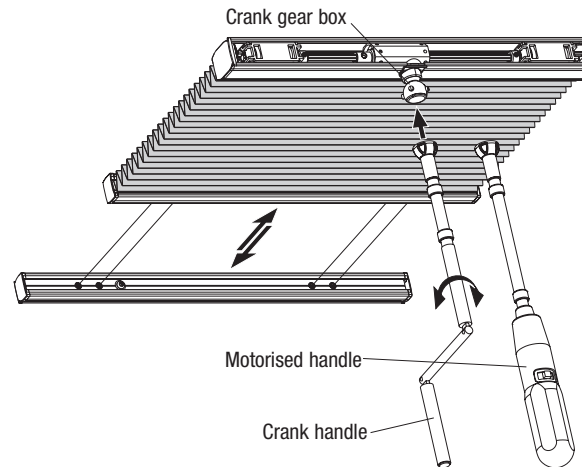

Operation Model P3600, P3634, P3635, P3636, P3637, P3650, P3662, P3663

Tensioned pleated blinds are opened and closed by moving the operating handle, using the control rod to help if necessary.

Attach the control rod to the operating handle.

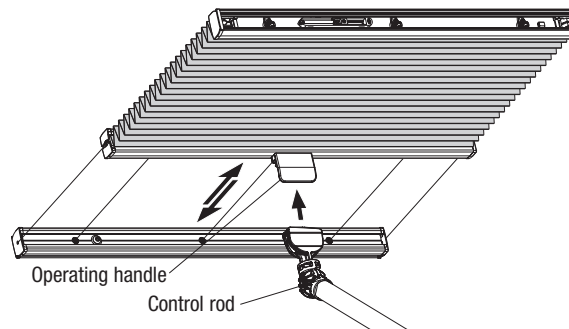

Care

Thanks to a special manufacturing process, our fabric qualities are furnished with an antistatic finish and are therefore resistant to dust and dirt. Occasional brushing with a soft brush or a feather duster is usually sufficient.

When cleaning glass and the window frame, make sure that no water or caustic cleaning agents come into contact with the fabric. No guarantee can be offered for damage to fabrics that is attributable to condensation, cleaning agents or soiling by insects.

Installation – Operation – Care

Model

P3700, P3900, P3902, P3600, P3800, P3802, P3634, P3635, P3636, P3637, P3650, P3662, P3663

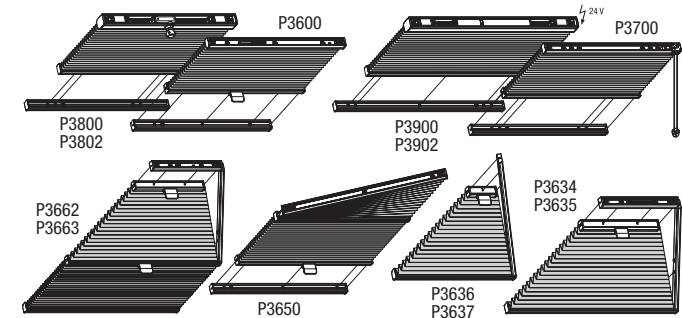

Dear Customer,

this dimensionally accurate blind was produced especially according to your requirements. High quality materials and a design that is perfect in function and elegance guarantee a long service lifetime and thus ensure great pleasure in the purchased product.

Your blind Manufacturer



Please read this instructions carefully before fitting the blind.



Blinds must be fitted by skilled personnel.

Wrong installation may result in accidents.

Alterations of the blind must be approved by the blind manufacturer.

No screws for fixing are enclosed. Always use appropriate screws and plugs suited for the wall or ceiling material where the blind is fitted!



WARNING



- Young children can strangle in the loop of pull cords, tapes and cords that operate window coverings. They can also wrap cords around their necks.
- To avoid strangulation and entanglement, keep cords out of reach of young children.
- Move beds, cots and furniture away from window covering cords.
- Do not tie cords together. Make sure cords do not twist and create a loop.
- Install and use the included safety devices according to the installation instructions on these device to reduce possibility of such an accident.



Mounting

When mounting the standard and motor/chain drive profile make sure that the distance between the clip and the end of the pleated blinds is 50 or 65 mm. Use only one clip per cord and/or drilled hole.

⚠ Attention: Use one clip per cord hole.
Assemble the clip directly under the cord hole.

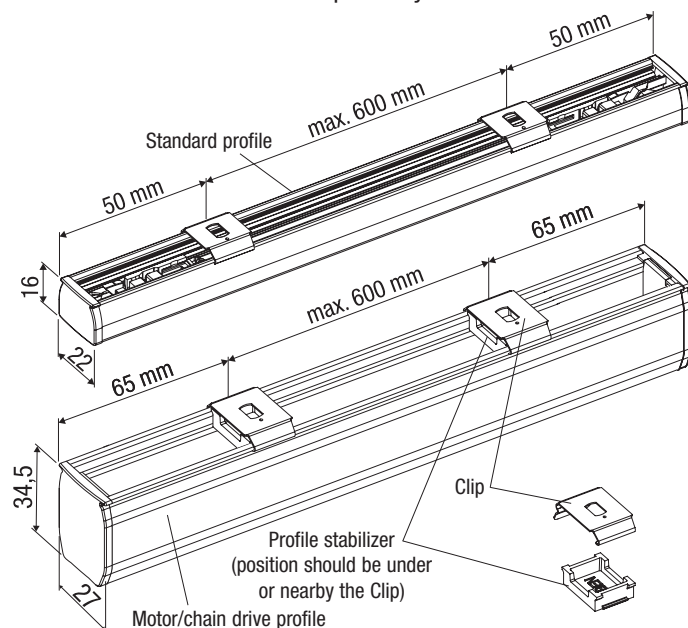

Mounting with clip

Recommendation: DIN 7981 Ø 3,9 x 16 mm
(for wooden and synthetic frames)

Insert the profile in the upper edge of the clip and press in downwards (until it clicks).

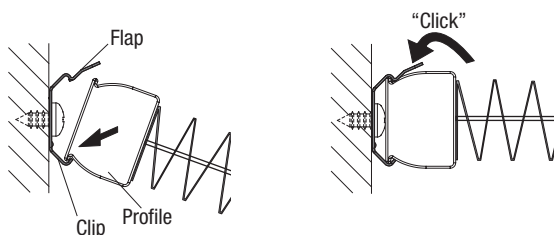

When **dismounting**, push the flap of the clip upwards to be able to take the profile out of the clip.

Mounting

Please ensure that there is a gap of at least 100 mm between the pleated blind and the glass pane to ensure sufficient ventilation. Furthermore, allowance should be made for ventilation gaps. If the air circulation is inadequate, this may lead to heat accumulation and the formation of condensation. We cannot accept any liability for damage to fabric caused by drip water or insect excrement.

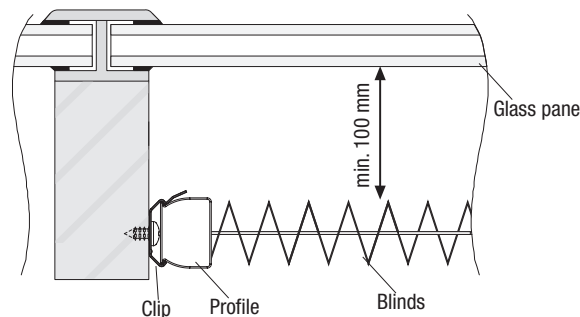

Mounting possibilities

Installation with mounting profile and clip

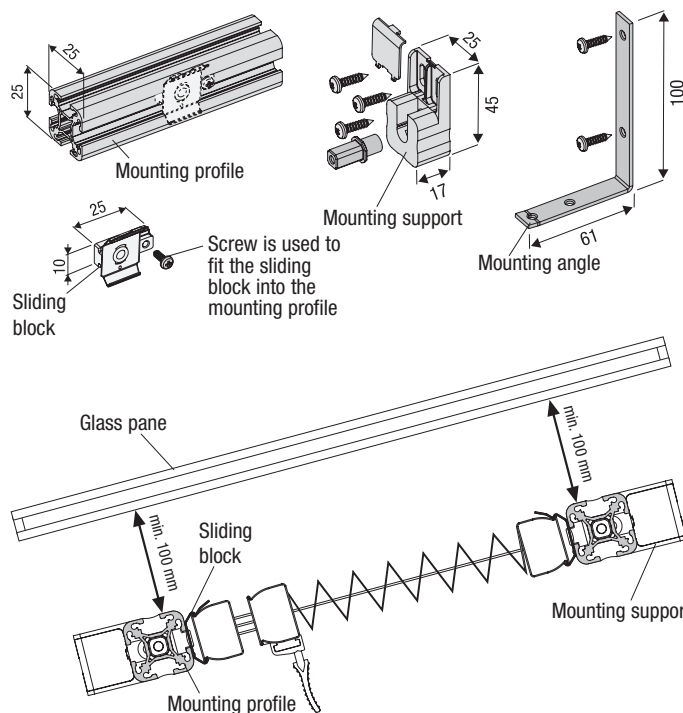

Mounting possibilities

Tensioned special models

1. Mount the operating handle.
 2. Mount the bottom clips and click the bottom profile in place.
 3. Mount the top clips and click the top profile in place.
 4. Mount the clips for side profile and click the side profile in place.
- Adjust the wire tension by use of the Allen key.

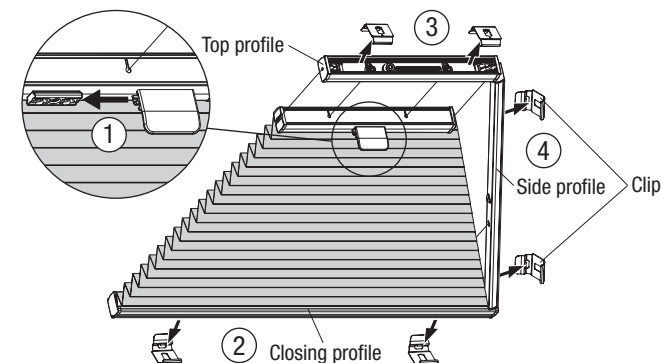

Stramming af wire

Final wire tensioning carried out **after** installation of the pleated blind.

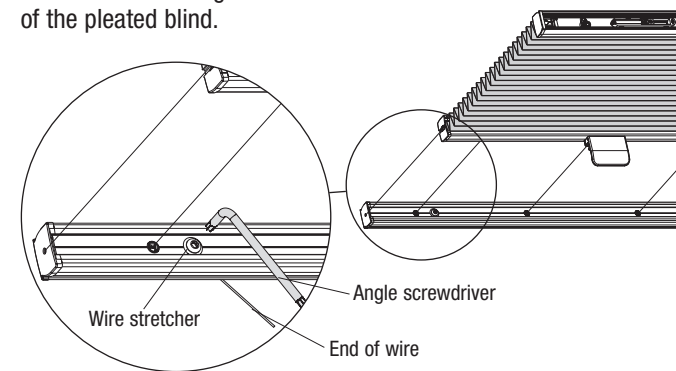

1. Secure the end of the wire by hand or using pliers.
2. Release the screw slightly (turn angle screwdriver anti-clockwise).
3. Tension the wire (by hand or use pliers).
4. Tighten the screw (turn angle screwdriver clockwise).
5. Final tensioning of the wire is achieved by further tightening of the wire stretcher.

For pleated blinds with more than one wire, repeat steps 1 to 5.

Note: Tension all wires evenly.