

Mounting

- c) Push the tension cord brackets over the fixing plates.

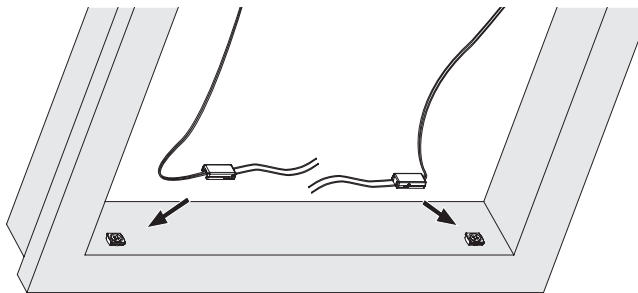

- d) Mount the operating handle.

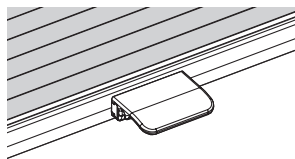
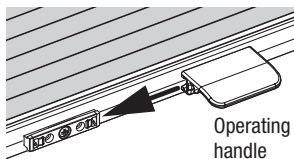

After having checked that the pleated blind functions as prescribed, the excess cord ends can be cut off.

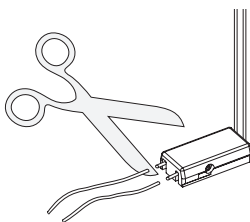

Attention: Adjustment of the cord tension must be uniform and may only be made by a professional.

Care

Thanks to a special manufacturing process, our fabric qualities are furnished with an antistatic finish and are therefore resistant to dust and dirt. Occasional brushing with a soft brush or a feather duster is usually sufficient.

When cleaning glass and the window frame, make sure that no water or caustic cleaning agents come into contact with the pleated blind fabric.

No guarantee can be offered for damage to fabrics that is attributable to Condensation, cleaning agents or soiling by insects.

Operation

Pleated blind with stretched cords are operated by use of the finger grip.

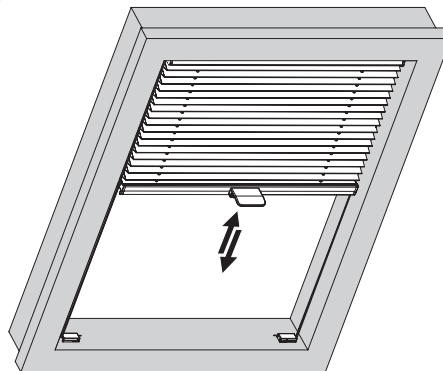

Attach the control rod to the operating handle.

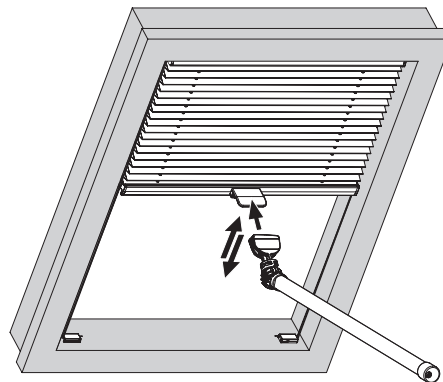

Locking

Click the operation profile over the tension cord bracket

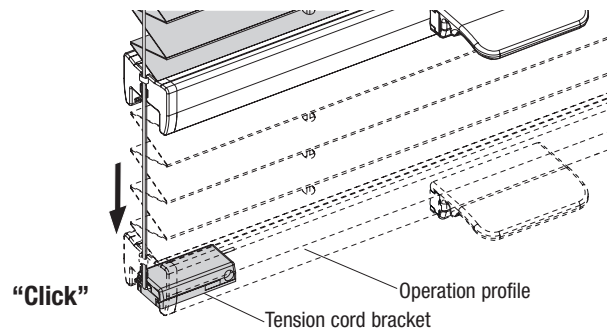

Installation – Operation – Care

Model P2600, P2620

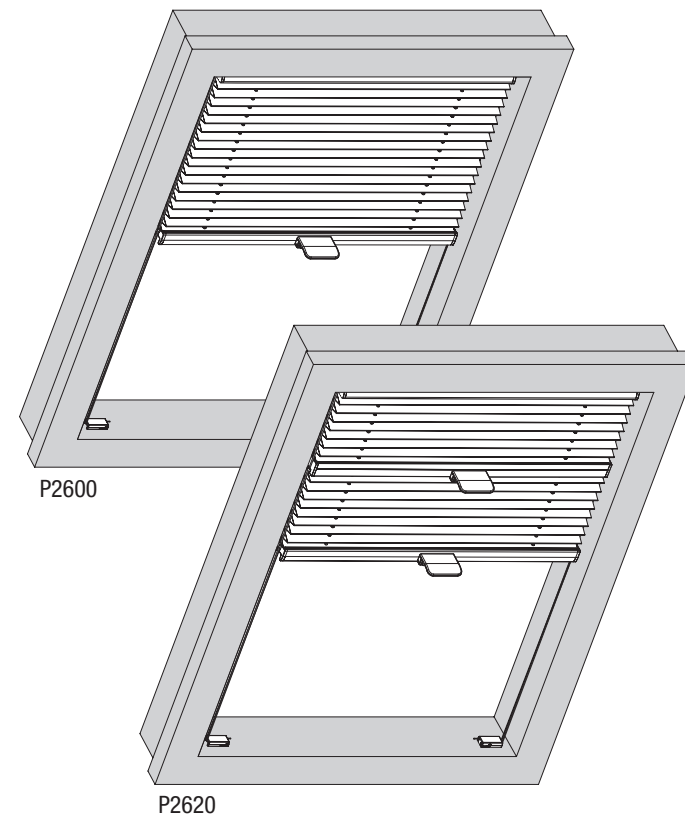

Dear Customer,

this dimensionally accurate pleated blind was produced especially according to your requirements. High quality materials and a design that is perfect in function and elegance guarantee a long service lifetime and thus ensure great pleasure in the purchased product.

Your pleated blind Manufacturer

Please read this instructions carefully before fitting the blind



Blinds must be fitted by skilled personnel. Wrong installation may result in accidents.

Alterations of the blind must be approved by the blind manufacturer.



No screws for fixing are enclosed.

Always use appropriate screws and plugs suited for the wall or ceiling material where the blind is fitted!

Mounting

1. Mount clips

- a) Mount the clips 50 mm from the end of the headrail, and with a distance of max. 600 mm.

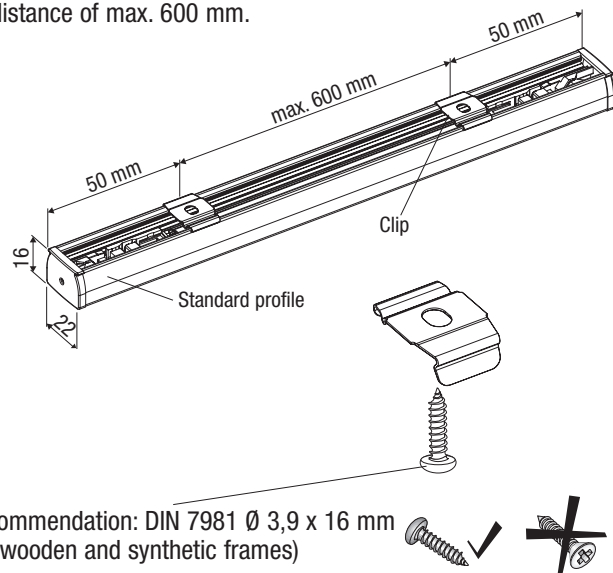

- b) Depending on the window type and brand the distance to the front edge of the window is determined by use of the mounting template. Mark up the drilling holes by use of a pin and fix the clips with the screws.

The window brands FAKRO and VELUX type GGU/GPU of an older generation with rounded front edge:

The profile distance from the front edge of the window must be 5 mm (hole distance 16 mm). Place the mounting template marked "+5" at the front edge.

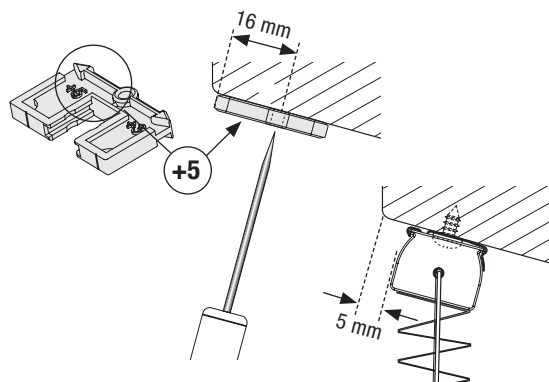

All other roof windows:

The profile distance from the front edge of the window must be 3 mm (hole distance 14 mm). Place the mounting template marked "+3" at the front edge.

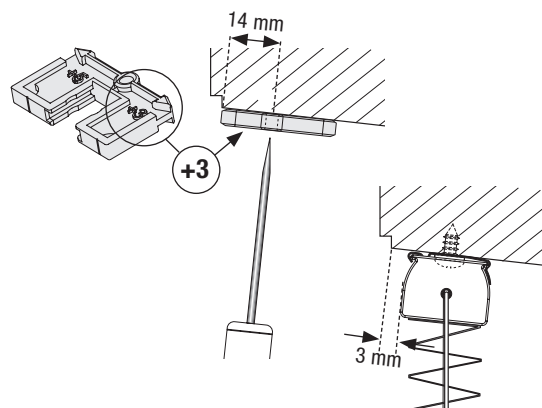

2. Mount the fixing plates for the tension cord brackets

- a) Determine the fixing plates' distance to the sides from the marking. Place the pleated blind in the middle of the window and mark the ends on the left and on the right.

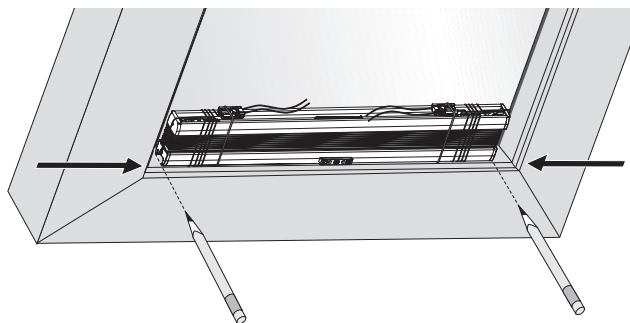

- b) Push the fixing plate into the mounting template.

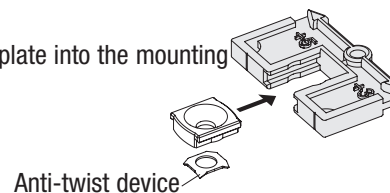

Mounting

- c) Place the mounting template - depending on the window type as already described - with "+5" or "+3" at the front edge of the window and the marking of the pleated blind width. Fix the fixing plates with the screws. Pull the mounting template away.

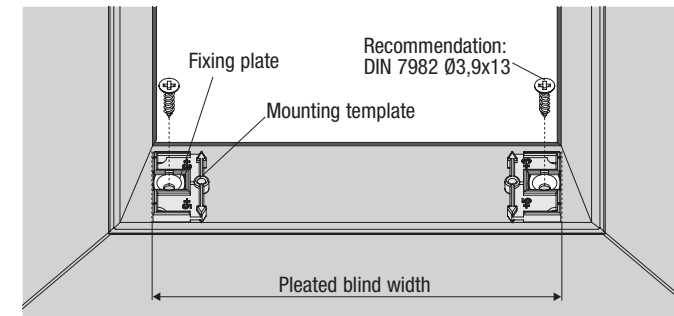

3. Mount the pleated blind

- a) Remove rubber band and unwind the cord incl. tension cord bracket.

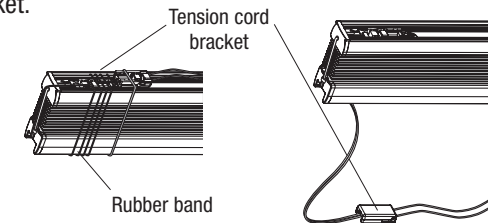

- b) **Installation:** Insert the profile in the upper edge of the clip and press in downwards (until it clicks).

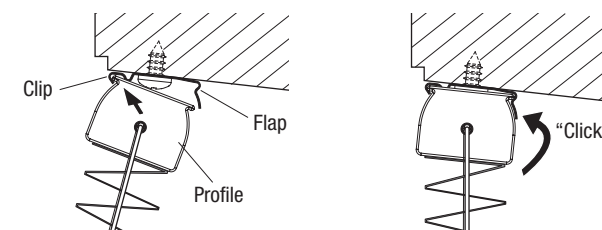

When **dismounting**, push the flap of the clip upwards to be able to take the profile out of the clip.