

Mounting of the tension cord bracket

Remove rubber band, unwind the cord incl. tension cord bracket and mount operating handles.

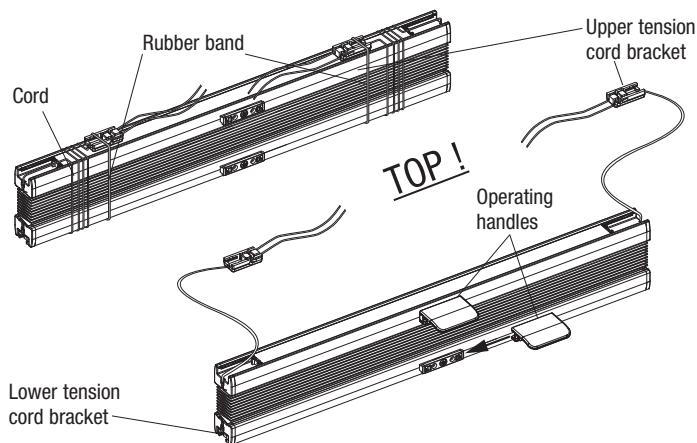

Push the **upper tension cord brackets** over the fixing plates until they lock.

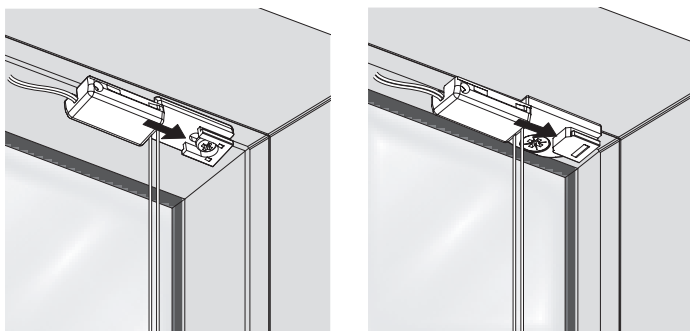

Take the **lower tension cord brackets** out of the rail and push them over the fixing plates until they lock.

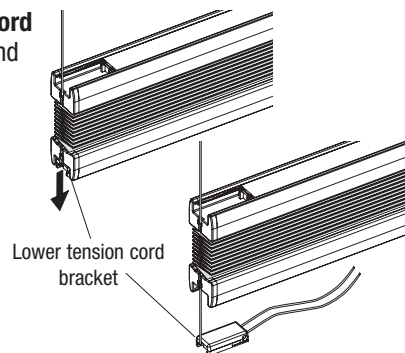

Operation

Pleated blind with stretched cords are operated by use of the finger grip.

Locking
Click the operation profile over the tension cord bracket.

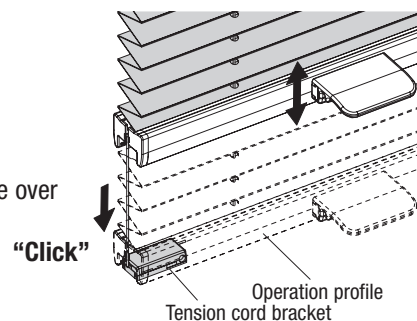

After having checked that the pleated blind functions as prescribed, the excess cord ends can be cut off.

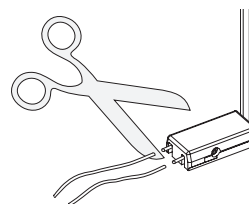

Attention: Adjustment of the cord tension must be uniform and may only be made by a professional.

Care

Thanks to a special manufacturing process, our fabric qualities are furnished with an antistatic finish and are therefore resistant to dust and dirt.

Occasional brushing with a soft brush or a feather duster is usually sufficient.

For further care information, refer to the cleaning instructions.

Installation – Operation – Care

Model P1615

with attachment bracket (flat)
with attachment bracket (edge)

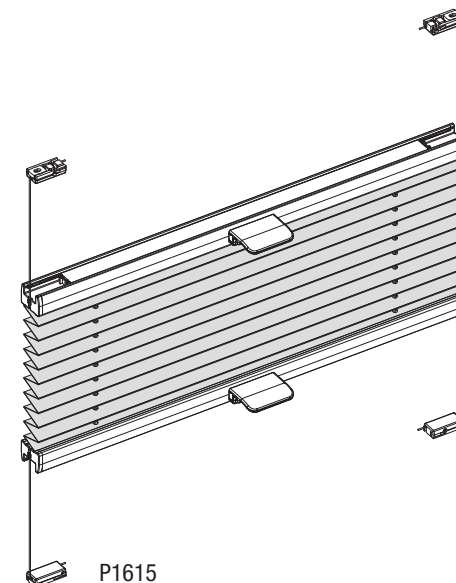

Dear Customer,

this dimensionally accurate pleated blind was produced especially according to your requirements. High quality materials and a design that is perfect in function and elegance guarantee a long service lifetime and thus ensure great pleasure in the purchased product.

Your pleated blind Manufacturer



Please read this instructions carefully before fitting the blind



Blinds must be fitted by skilled personnel.

Wrong installation may result in accidents.

Alterations of the blind must be approved by the blind manufacturer.

No screws for fixing are enclosed.

Always use appropriate screws and plugs suited for the wall or ceiling material where the blind is fitted!

Mounting of the tension cord bracket

Information to all mounting types:

Determination and marking of the position for the clamping shoe (always the outer edge of the blind = ordering width).

The ordered width is easy to find by placing the pleated blind in the window frame and marking the ends.

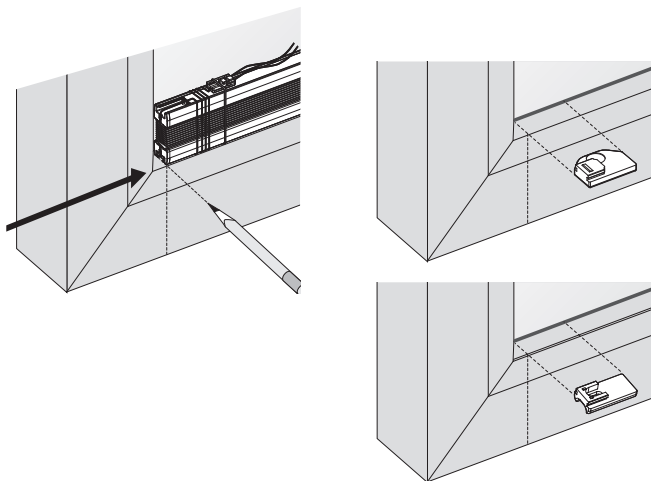

Mounting possibilities

Glass strip mounting with attachment bracket (flat)

Insert anti-twist protection at the bottom of the attachment bracket (flat).

Place the attachment bracket at the seal and slide as far as the marking.

Tighten the screw hand-tight.

Recommendation:
DIN 7982
Ø 3.9 x 13 mm
(for wooden and synthetic frames)

Slide the clamping shoe onto the attachment bracket (flat). (see clamping shoe installation)

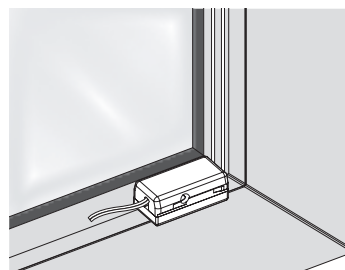
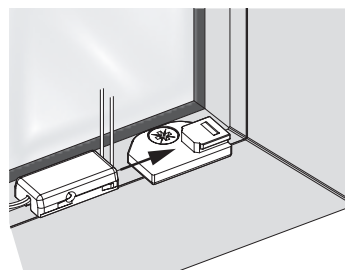
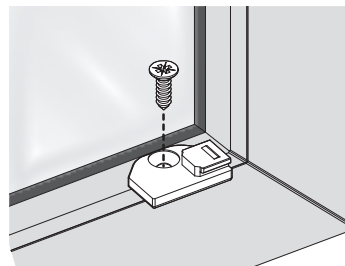
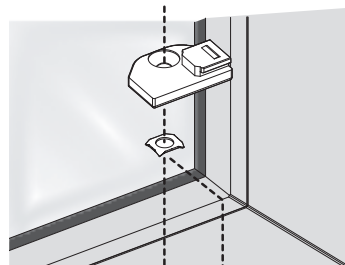

Mounting possibilities

Glass strip mounting with attachment bracket (edge)

Position fixing bracket (edge) at marking.

Tighten the screw hand-tight.

Recommendation:
DIN 7904
Ø 2.9 x 9.5 mm
(for wooden and synthetic frames)

Slide the clamping shoe onto the attachment bracket (flat). (see clamping shoe installation)

