

Tensioned models

For all special models with a fixed bottom profile:

1. Mount the bottom clips and click the bottom profile in place.
2. Mount the top clips and click the top profile in place.
3. Mount the clips for side profile and click the side profile in place.
4. Mount the operating handle.

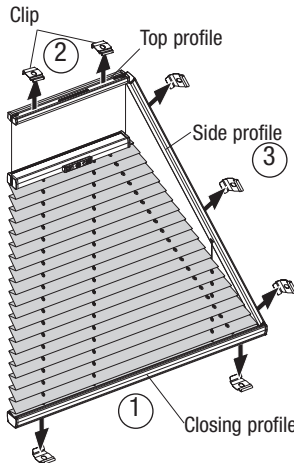

For model P1650:

1. Mount the top clips and click the top profile in place.
2. Fix the retaining brackets as already described.
3. Mount the operating handle.

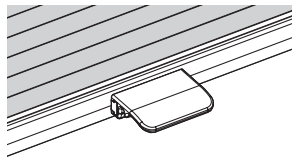
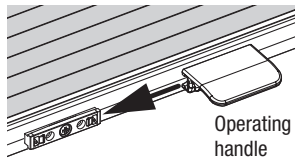
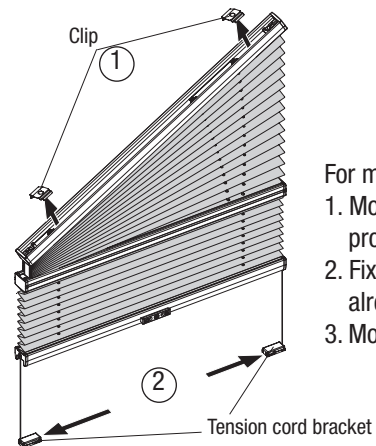

Stationary models

Fit the clips and click in the profiles. Fit additional hooks behind the position of the fabric rivets and insert the fabric.

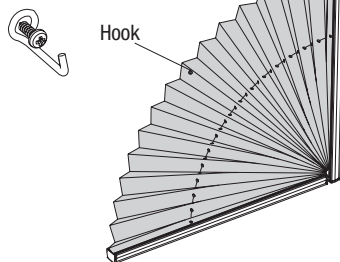

Operation Model P1634, P1635, P1636, P1637, P1650, P1662, P1663

Tensioned pleated blind is closed and opened by moving the operating handle.

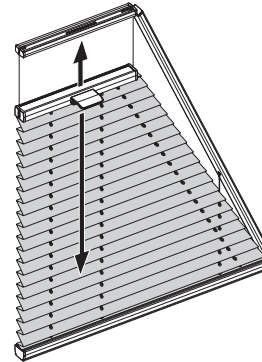

Operation Model P1001, P1043, P1044, P1082, P1086

These pleated blind models are stationary and cannot be operated.

Model P1634, P1635, P1636, P1637, P1650, P1662, P1663, P1001, P1043, P1044, P1082, P1086vv

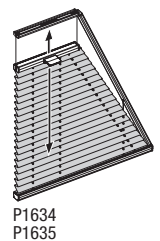
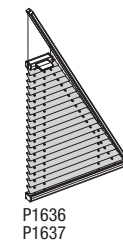
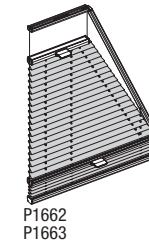

Dear Customer,

this dimensionally accurate pleated blind was produced especially according to your requirements. High quality materials and a design that is perfect in function and elegance guarantee a long service lifetime and thus ensure great pleasure in the purchased product.

Your pleated blind Manufacturer

Care

Thanks to a special manufacturing process, our fabric qualities are furnished with an antistatic finish and are therefore resistant to dust and dirt. Occasional brushing with a soft brush or a feather duster is usually sufficient.

When cleaning glass and the window frame, make sure that no water or caustic cleaning agents come into contact with the pleated blind fabric.

No guarantee can be offered for damage to fabrics that is attributable to condensation, cleaning agents or soiling by insects.

Please read this instructions carefully before fitting the blind



Blinds must be fitted by skilled personnel. Wrong installation may result in accidents.

Installation work in the 230 V range must only be carried out by authorized specialist.

Alterations of the blind must be approved by the blind manufacturer.

No screws for fixing are enclosed.

Always use appropriate screws and plugs suited for the wall or ceiling material where the blind is fitted!



Clip mounting

Mount the clips 50 mm respectively from the end of the headrail, and with a distance of max. 600 mm.

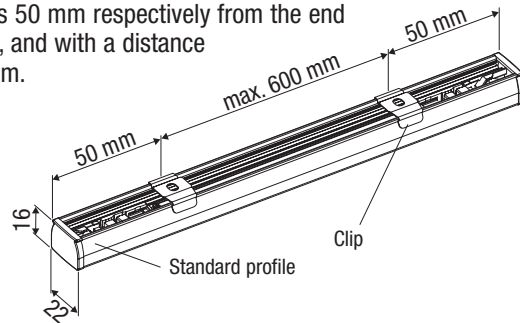

All dimensions in millimetre!

Attention: It is recommended to mount the clip with the flap forward (into the room). The clip can **only** be mounted with the flap toward the window or the pane respectively, in case the distance to the rail is **min. 7 mm**.

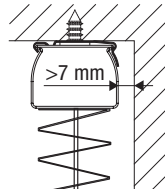

Ceiling mounting with clip

Place the profile in the back edge of the clip and push the front of the profile upwards (till it clicks in).

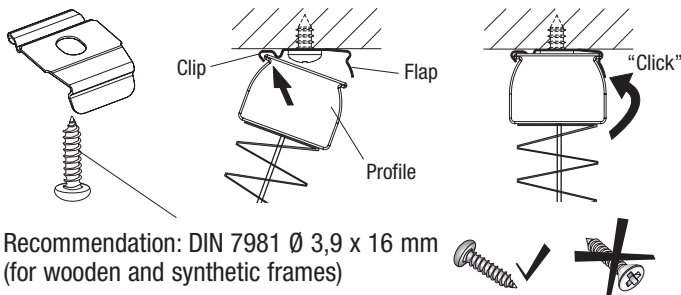

Recommendation: DIN 7981 Ø 3,9 x 16 mm (for wooden and synthetic frames)

When **dismounting**, push the flap of the clip upwards to be able to take the profile out of the clip.

Mounting possibilities

Wall installation with mounting bracket and clip

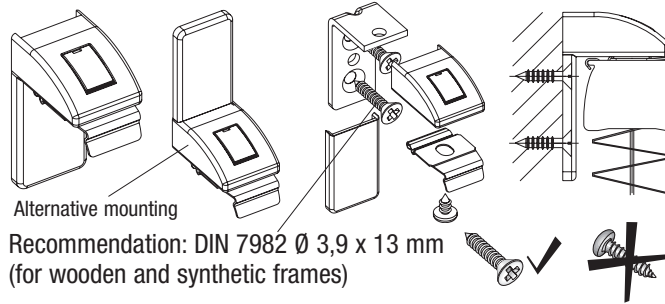

Recommendation: DIN 7982 Ø 3,9 x 13 mm (for wooden and synthetic frames)

Dismantle mounting bracket

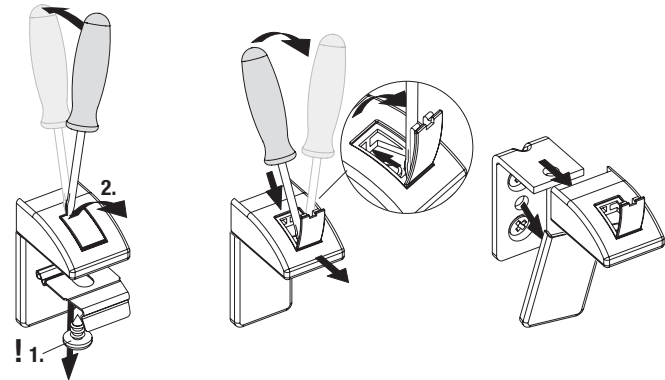

Installing the window moulding with moulding locking strip and clip

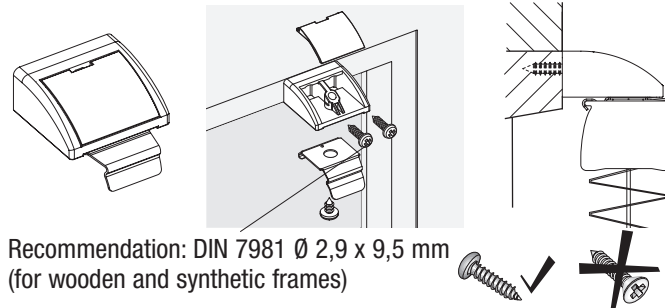

Recommendation: DIN 7981 Ø 2,9 x 9,5 mm (for wooden and synthetic frames)

Wall installation with fixed or adjustable wall mount and clip

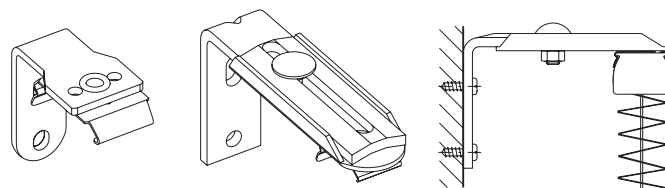

Mounting possibilities

Mounting of tension cord bracket (Typ P1650)

Let down the blind and mark the position for the clamping shoe (always the outer edge of the blind). Screw on holding brackets, mounting bracket or window moulding. Pull out and extend the tension cord bracket.

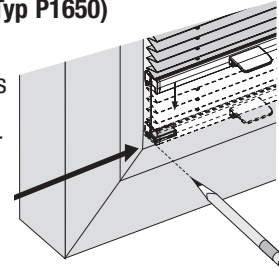

Holding brackets Mounting bracket Window moulding

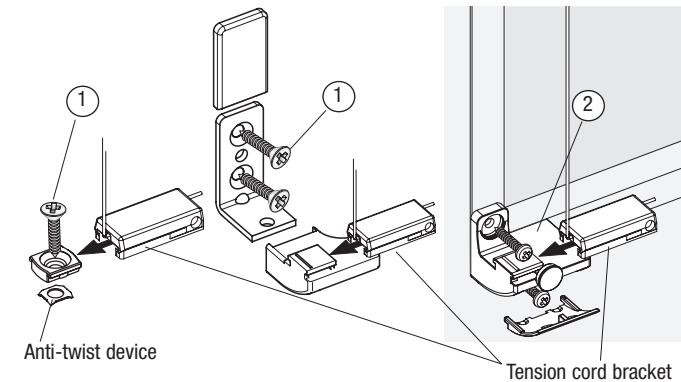

Anti-twist device

Tension cord bracket

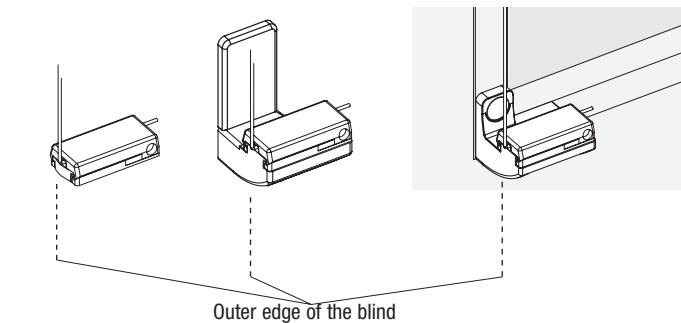

Outer edge of the blind

① Recommendation: DIN 7982 Ø 3,9 x 13 mm (for wooden and synthetic frames)

② Recommendation: DIN 7981 Ø 2,9 x 9,5 mm (for wooden and synthetic frames)
Max. length of the screw = window moulding depth!

For **fixing plates** use **mounting template (green)** see separate sheet.

